



Architects: Isasi & Pieltáin Arquitectos | Photographer: Ambassador

# GALÈNE

PANORAMIC SLIDING WINDOW







# GALÈNE, an xxi slider



Architects: Isasi & Pieltáin Arquitectos Photographer: Ambassador

## Generously-sized openings to meet your project's requirements

GALÈNE is a 126 mm module thermal break patio door featuring a lift and slide system and whose design has been optimised for use in large openings up to 10 m wide.

## Easy of movement

The lift and slide mechanism allows the guiding wheels to retract when the leaf is closed. This roller track system ensures smooth movement and easy operation despite the exceptional size of the leaves. The design of the pull handle allows for excellent grip.

A version without a thermal break is also available using the same configurations for geographical areas that do not have the same thermal constraints.



# GALÈNE

panoramic  
sliding window

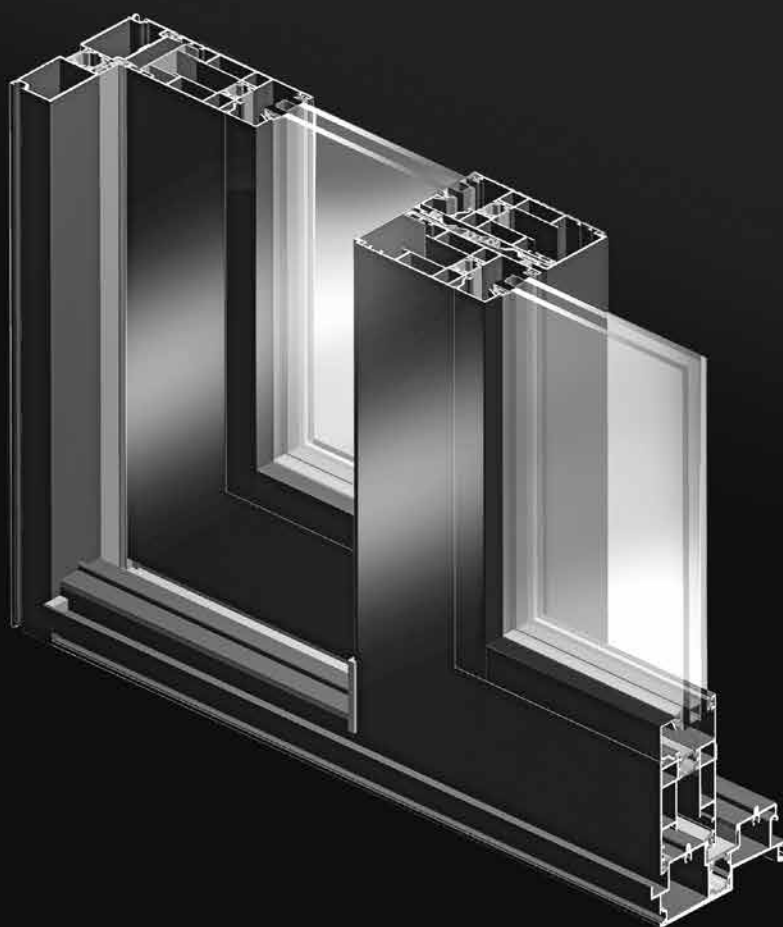



# Key features and innovations

## Large dimensions

- Designed for the creation of openings with large dimensions for more natural light.
- Dimensions up to 5.00 m x 2.5 m in frames with two leaves with a maximum weight of 300 kg per leaf.

## Acoustic performance

- In urban environments, road noise corresponds to an average level of 60 decibels.
- Thanks to these glazed infills, GALÈNE is able to dramatically reduce urban noise.

## Accessibility and ease of use

- A lifting system ensures that the large leaves are easy to move and slide smoothly.
- A handle offering a good grip and ease of movement.

## Locking mechanisms

- 2-,3- or 4-point locking systems activated by a special handle (single or double).
- Half-open position provides ventilation whilst ensuring that the frame is still secure.



# GALÈNE, a design with large dimensions

- Symmetrical glazed infills thanks to a mitre-cut peripheral opening frame.
- “Technical” glazing combining high levels of thermal, acoustic and security performance.
- Possibility of glazing with an integrated blind for solar protection.



Architect: Esther Santos Photographer: Wenzel



## Locking mechanisms, ease of movement and security

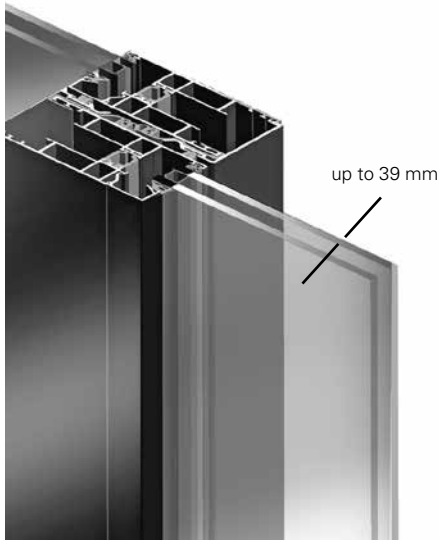

Pull handle

The lift and slide system facilitates the safe movement of the leaves which may each weigh up to 300 kg and measure up to 2.50 metres high by 2.50 metres wide.

Security can be reinforced by the implementation of a multipoint locking system activated by a specially-designed handle. In all cases, this remains very easy to use, thanks, in particular, to the well-designed profile combined with the high leverage. The operation of the GALENE slider has received level 4 classification in accordance with the standard EN 1191.2001, following 20,000 opening and closing test cycles.



# Sections

## 2 leaves - 2 tracks

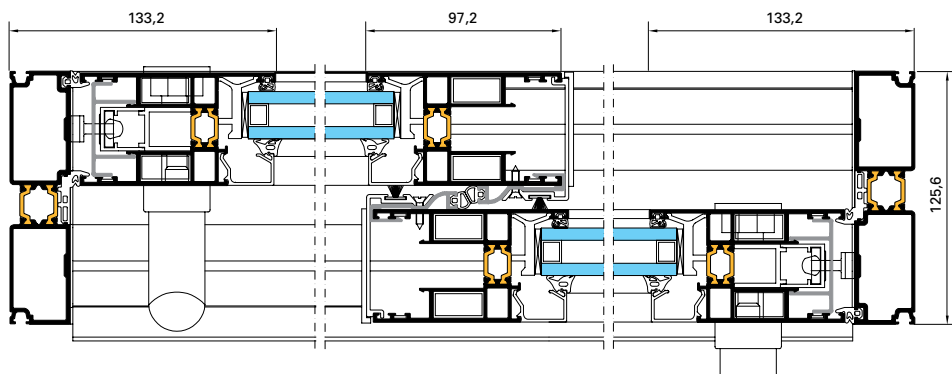

## 1 leaf + 1 light - 2 tracks

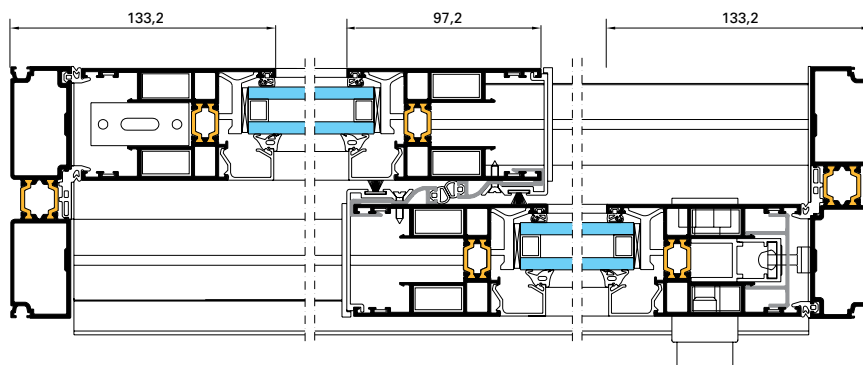

## 2 tracks\*

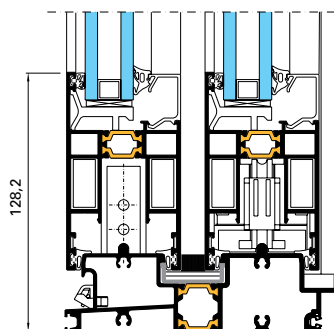

\* Available in France at the beginning of 2014



### 3 leaves - 2 tracks

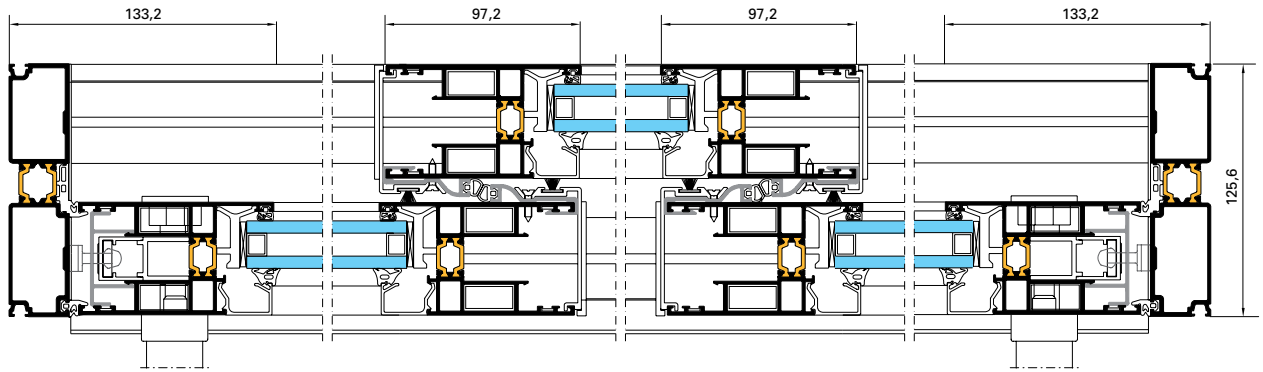

### 4 leaves - 2 tracks

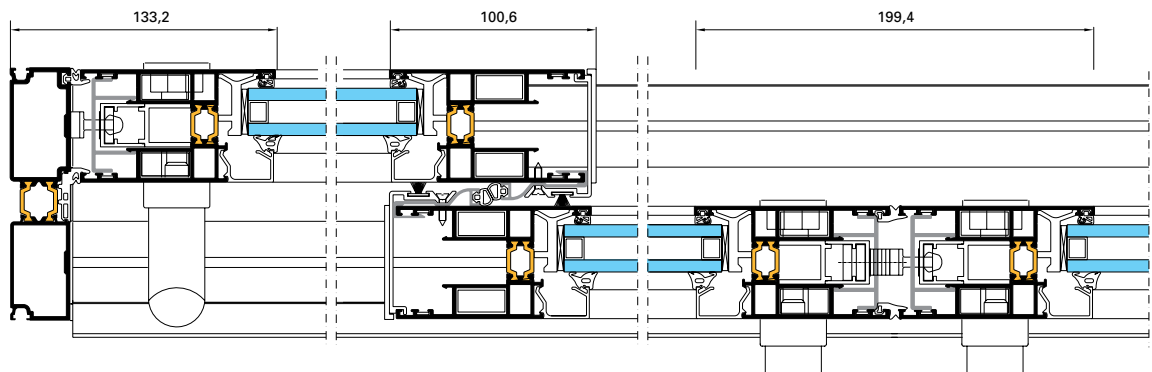

### 4 leaves + 2 side lights - 2 tracks

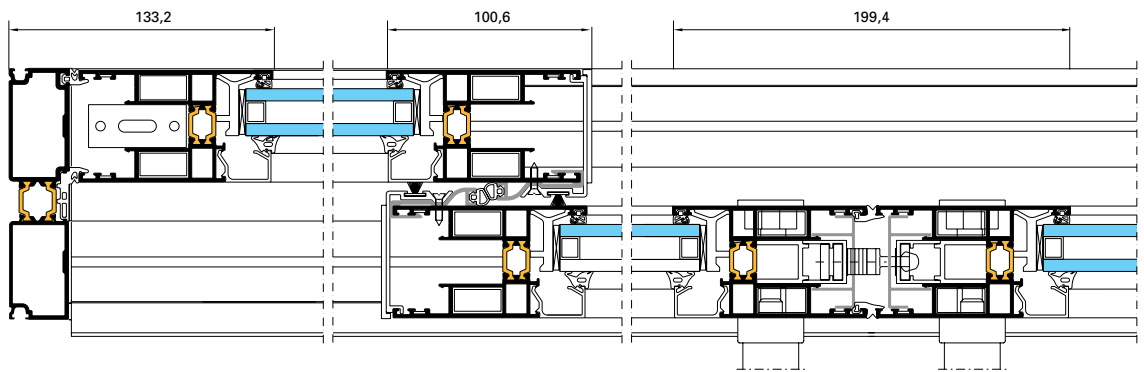



# Sections

2 leaves (90°)\*

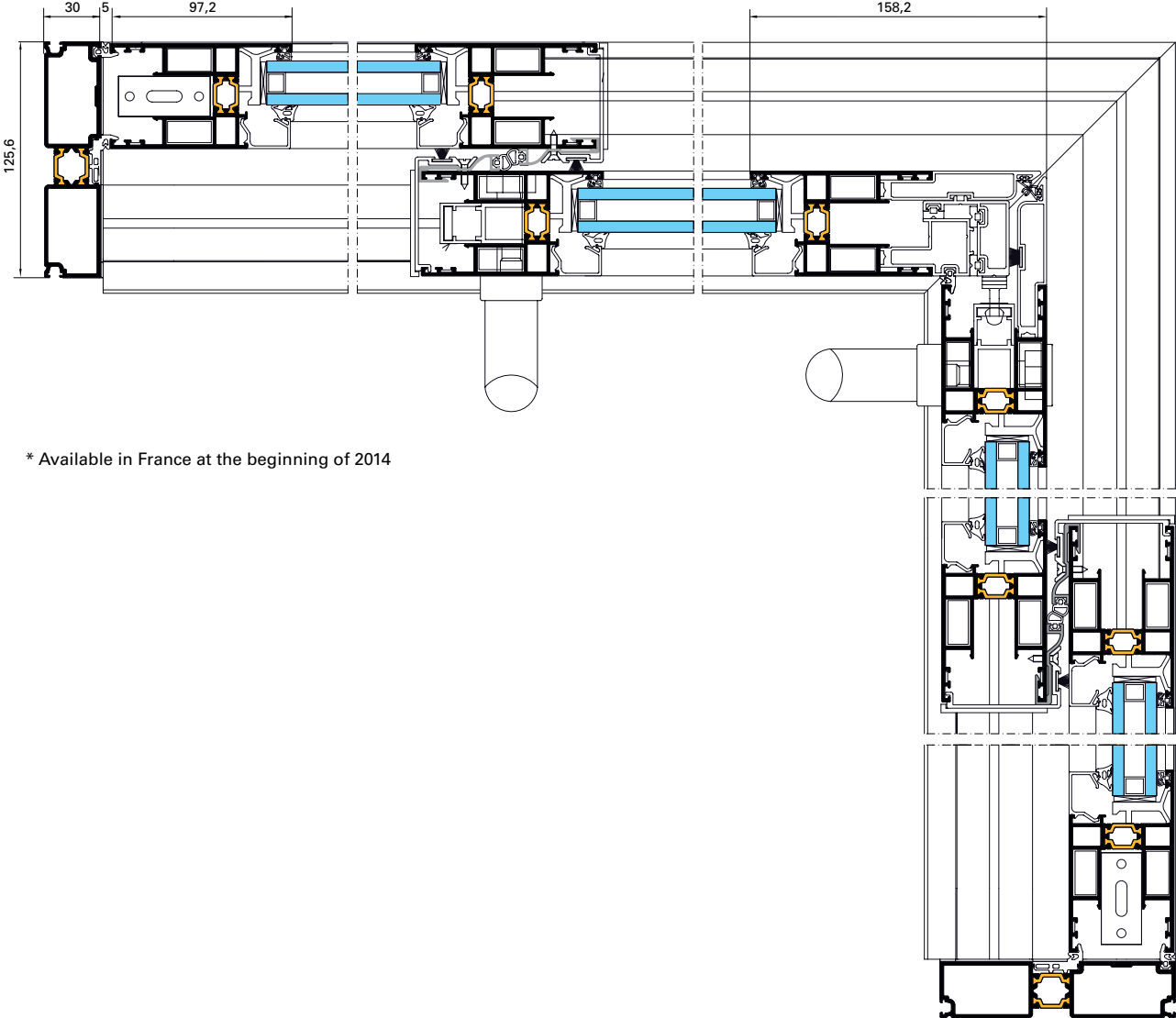

\* Available in France at the beginning of 2014



# Sections

3 leaves - 3 tracks\*

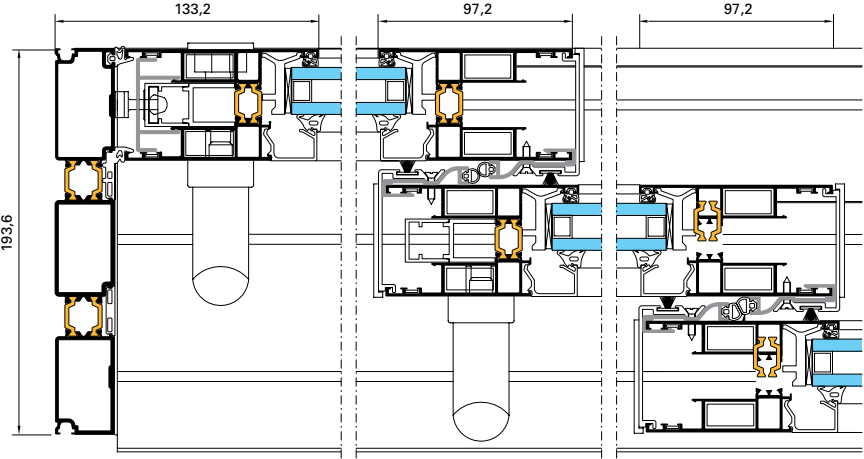

3 leaves - 1 side lights - 3 tracks\*

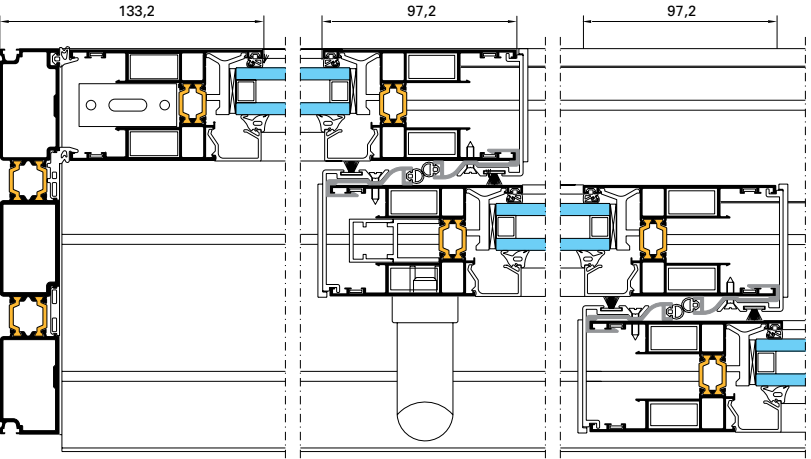



## 6 leaves - 2 side lights - 3 tracks\*

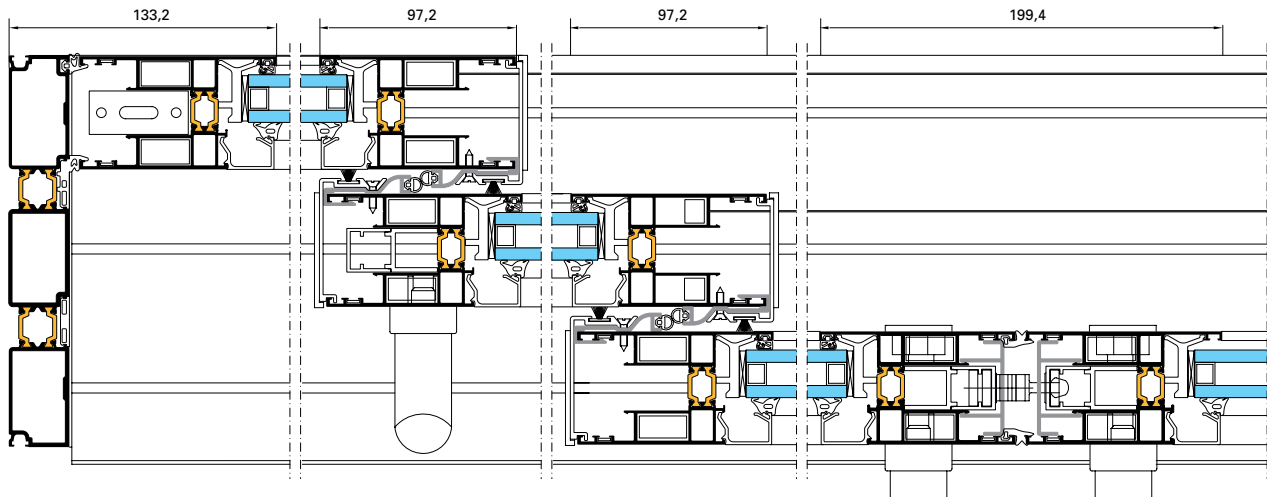

## 3 leaves - 3 tracks\*

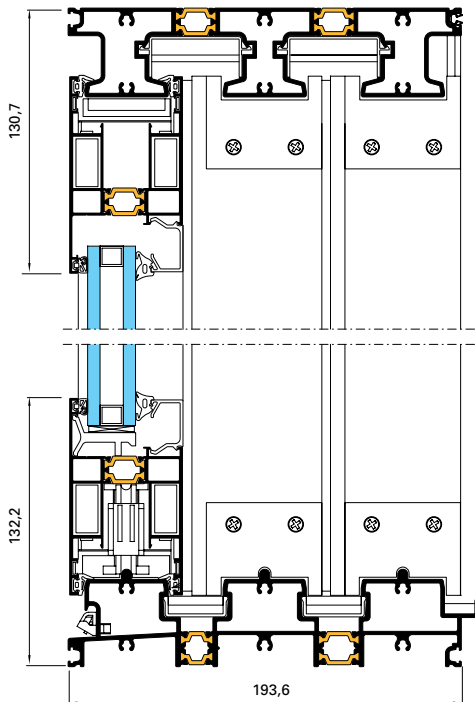

\* Available in France at the beginning of 2014

# Sections

## Pocket windows

1 leaf - 1 tracks\*

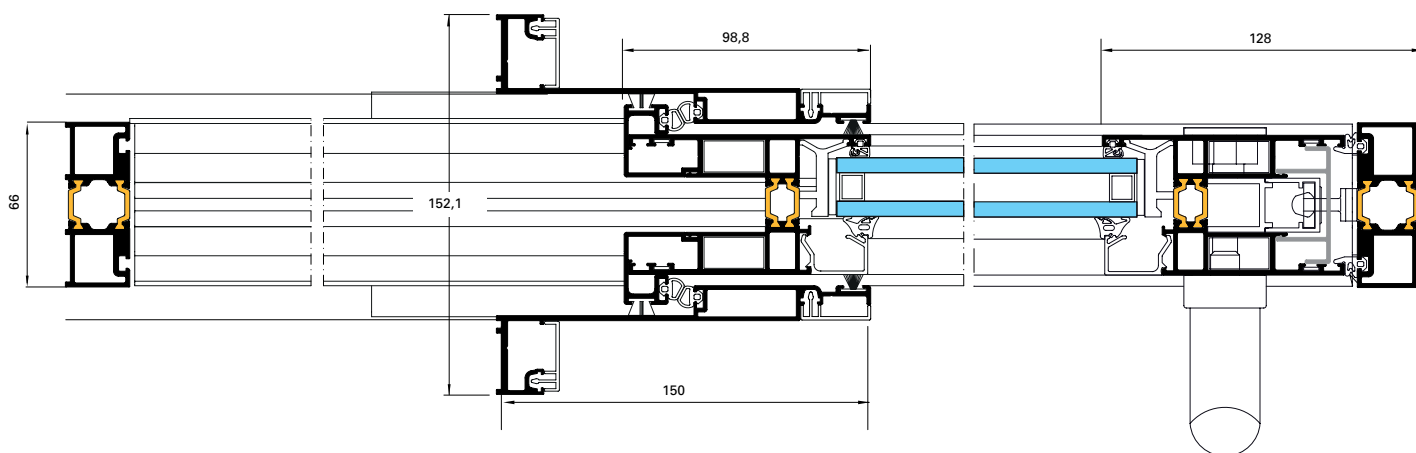

14

2-leaf - 1 track\*

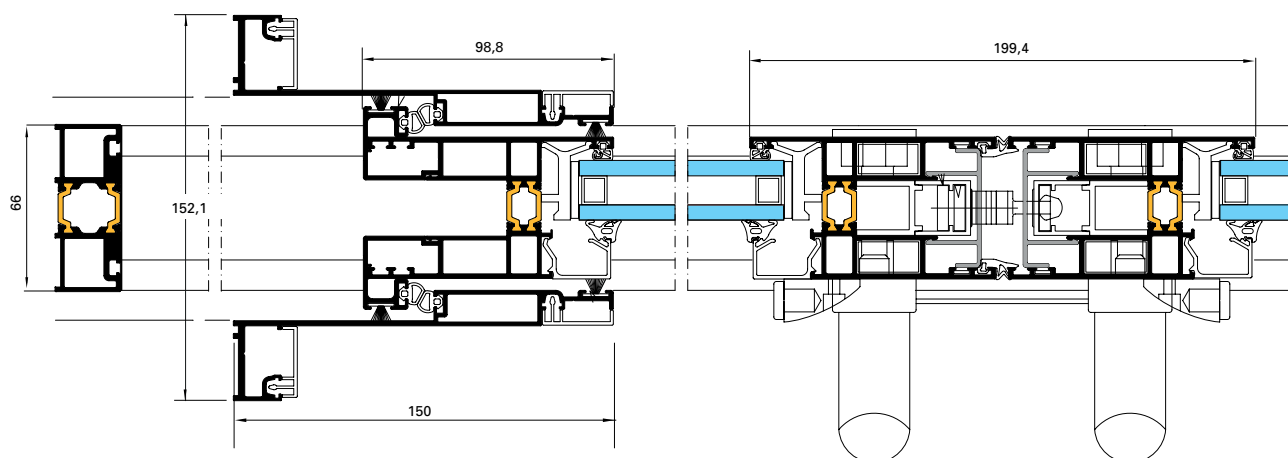

\* Available in France at the beginning of 2014

# Pocket windows

1 track\*

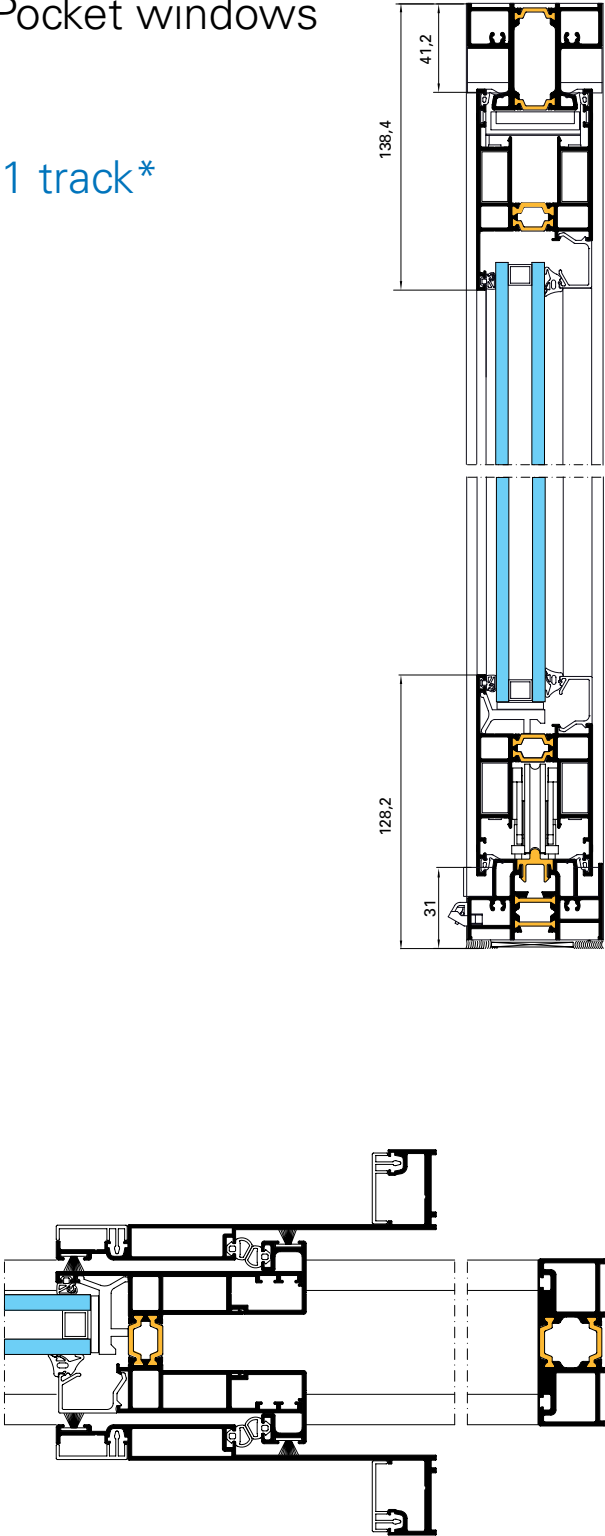

# Applications

## 2 tracks

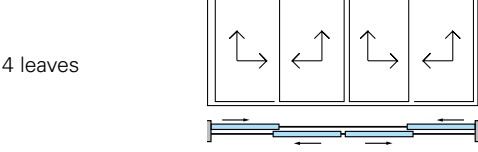
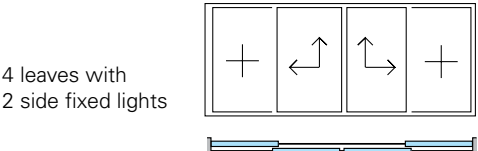
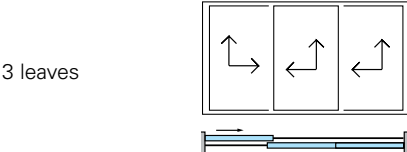
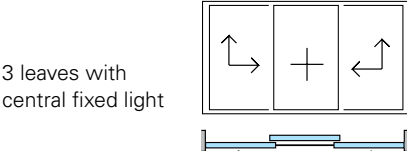
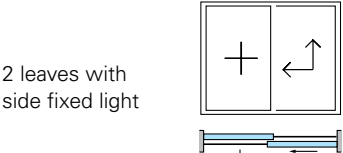
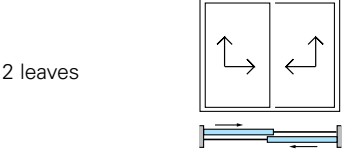

## 3 tracks\*

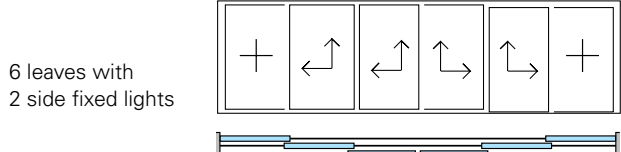
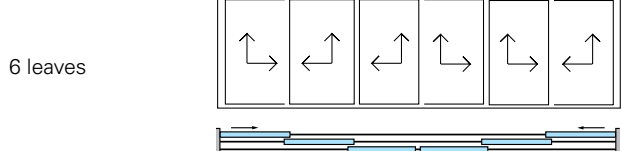
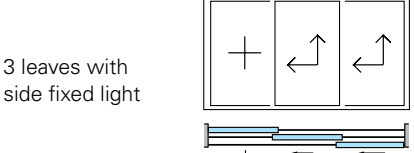
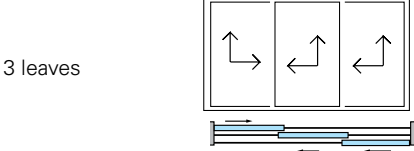

## Pocket window frame\*

### 1 track

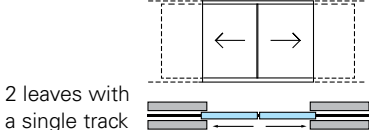
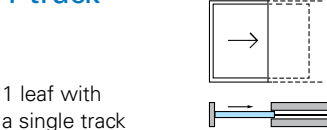

\* Available in France at the beginning of 2014



# Performance

THERMAL PERFORMANCE			
Type	Dimensions W x H in m	Uw with Ug 1.0 + Insulating spacer	Uw with Ug 1.1 + Insulating spacer
Patio door with 2 leaves on 2 tracks	5 x 2.5	1.6	1.7
Patio door with 4 leaves on 2 tracks	6.5 x 2.5	1.7	1.7
Patio door with 3 leaves on 3 tracks	6.5 x 2.5	1.6	1.7

PERFORMANCE - SOLAR FACTOR			
Type	Dimensions W x H in m	Absorption depending on colours SW Winter	
		Light colours 0.4	Dark colours 1.0
Sg solar factor of the glazing only 0.7			
Patio door with 2 leaves on 2 tracks	5 x 2.5	0.59	0.61
Patio door with 4 leaves on 2 tracks	6.5 x 2.5	0.58	0.59
Patio door with 3 leaves on 3 tracks	6.5 x 2.5	0.59	0.61

TECHNICAL PERFORMANCE - LIGHT TRANSMISSION		
Type	Dimensions W x H in m	TLw light transmission of the window
TLg light transmission of the glazing only 0.8		
Patio door with 2 leaves on 2 tracks	5 x 2.5	0.66
Patio door with 4 leaves on 2 tracks	6.5 x 2.5	0.64
Patio door with 3 leaves on 3 tracks	6.5 x 2.5	0.66

WEATHER PERFORMANCE: A.E.V. (A: Air, E: Water, V: Wind)				
Type	Dimensions W x H in m	A	E	V
Patio door with 2 leaves on 2 tracks	3 x 2.2	4	7A	C3
Patio door with 4 leaves on 2 tracks	3 x 2.2	3	5A	C4
Patio door with 3 leaves on 3 tracks	3.76 x 2.5	3	5A	C2



## Materials and parts

As with all Technal systems, only the highest quality materials and components are used to minimise maintenance and ensure long-term performance.

- Aluminium profiles are extruded from 6060 T5 EN 12020, EN 573-3, EN 515 and EN 775-1 to 9 alloys.
- Fittings are cast from EN 12844 compliant Zamak 5.
- All gaskets are EPDM or TPE (Thermoplastic elastomer).
- Polyamide thermal breaks are extruded from pA6-6 (0.25 FV).
- Screws are made from stainless steel.

## Finishes and colours

A wide range of finishes and colours is available to meet individual project requirements, enhancing existing buildings and offering architects and designers greater design freedom:

- Natural anodised in accordance with EN 123731: 2001.
- Polyester powder coating finishes in a wide range of colours in accordance with "QUALICOAT".
- GALÈNE is also available in lacquered finishes with exclusive Technal colours for a stylish and contemporary look.



Architects: Ángel Sánchez-Cantalejo and Vicente Tomás Photographer: Alejo Bagueé





1



2



3

1. Architects: Isasi & Pieltáin Arquitectos Photographer: Ambassador
2. Architect: Bach Arquitectes Photographer: José Hevia
3. Architect: Joan Prat (CPVA Arquitectes) Photographer: Jordi Canosa